

HIGHLIGHTS OF OPTION 1:

- A. NEW PEDESTRIAN TRAIL**
- B. NEW FITNESS STATIONS**
- C. NEW PICKLEBALL COURT**
- D. NEW PLAYGROUND**
- E. NEW PUTTING GREEN**
- F. NEW BENCH SEATING**
- G. ELEVATED PICNIC DECK**
- H. RECONFIGURED HALF BASKETBALL COURT**
- I. UPDATED BOCCE BALL**

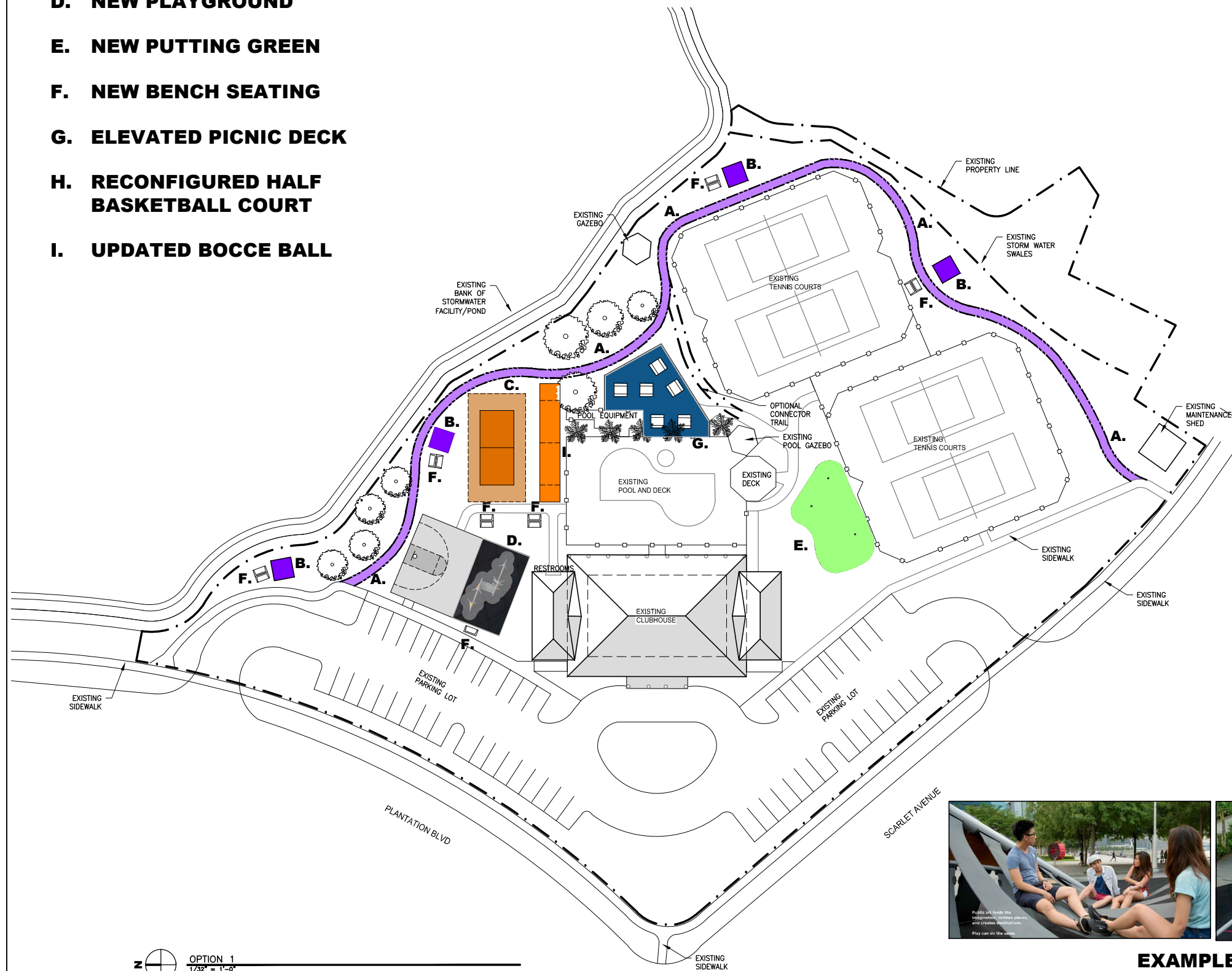

EXAMPLE FITNESS TRAIL (A.)



EXAMPLE FITNESS STATIONS (B.)
(PLAYWORLD LIFE TRAIL SYSTEMS)



EXAMPLE PICKLEBALL COURT (C.)



EXAMPLE PLAY SYSTEM MULTIPLE AGE GROUPS (D.)
(PLAYWORLD SYSTEMS)

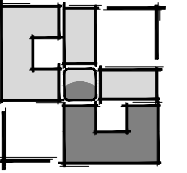

UGARTE
& ASSOCIATES, INC.
ARCHITECTURE
PLANNING

434 9th AVENUE WEST
PALMETTO, FLORIDA 34221
PHONE (941) 729-5691
FAX (941) 729-5692
WWW.UGARTEARCHITECTURE.COM
— AA-C001654 —

SITE OPTION 1

LAKESIDE PLANTATION CDD

REVISIONS

PRELIMINARY
NOT FOR
CONSTRUCTION

PROJECT NO: 2016-01
DATE: --/--
DRAWN BY: --
CHKD BY: --

CARLOS D. UGARTE
LIC. NO. AR-0010725

SHEET

A100

4/16/2016 2:22 PM CAD_DWG_FILE:A100_SITE_OPTION_1.DWG COPYRIGHT: UGARTE & ASSOCIATES, INC. 2014

HIGHLIGHTS OF OPTION 2:

- A. NEW PEDESTRIAN TRAIL**
- B. NEW FITNESS STATIONS**
- C. NEW PICKLEBALL COURT**
- D. NEW PLAYGROUND**
- E. NEW PUTTING GREEN**
- F. NEW BENCH SEATING**
- G. ELEVATED PICNIC DECK**
- H. RECONFIGURED HALF BASKETBALL COURT**
- I. UPDATED BOCCE BALL**
- J. NEW DOG PARK**
- K. NEW ELEVATED WALK WAY**
- L. NEW GAZEBO IN POND**

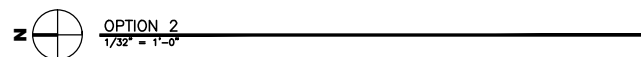
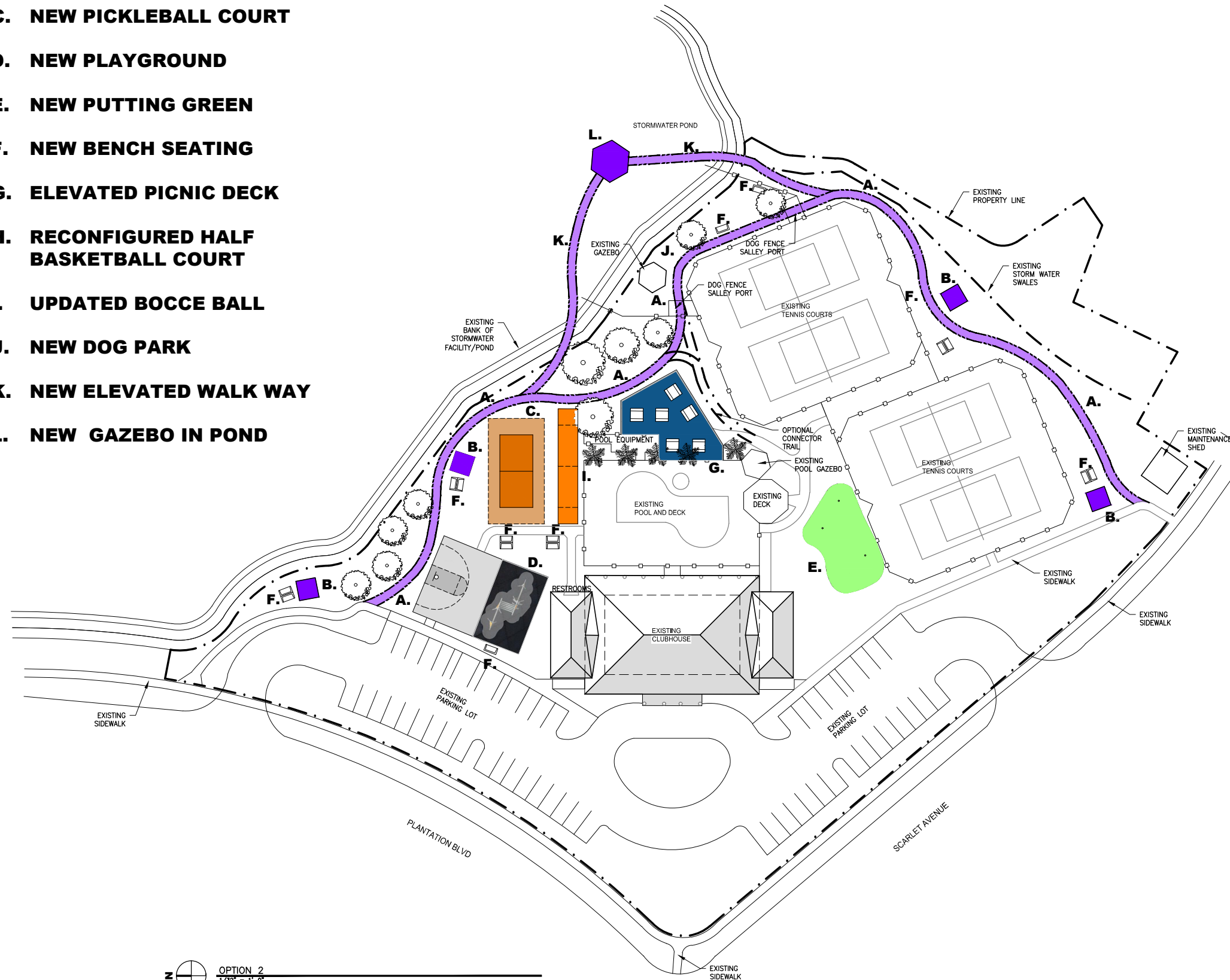

EXAMPLE PUTTING GREEN (E.)



EXAMPLE GAZEBO AND WALK WAY OVER POND (L. + K.)



EXAMPLE DOG PARKS (J.)



EXAMPLE DOG PARK SALLY PORT - SECURITY

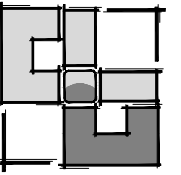

UGARTE & ASSOCIATES, INC.
ARCHITECTURE
PLANNING

434 9th AVENUE WEST
PALMETTO, FLORIDA 34221
PHONE (941) 729-5691
FAX (941) 729-5692
WWW.UGARTEARCHITECTURE.COM
— AA-C001654 —

SITE OPTION 2

LAKESIDE PLANTATION CDD

REVISIONS
PRELIMINARY NOT FOR CONSTRUCTION
PROJECT NO: 2016-01
DATE: --/--
DRAWN BY: --
CHKD BY: --
CARLOS D. UGARTE LIC. NO. AR-0010725

4/16/2016 2:21 PM CAD_DWG_FILE:A200_SITE_OPTION_2.DWG

COPYRIGHT: UGARTE & ASSOCIATES, INC. 2014

SHEET
A200

HIGHLIGHTS OF OPTION 3:

- A. NEW PEDESTRIAN TRAIL**
- B. NEW FITNESS STATIONS**
- C. NEW PICKLEBALL COURT(S)**
- D. NEW PLAYGROUND**
- E. NO PUTTING GREEN THIS OPTION**
- F. NEW BENCH SEATING**
- G. ELEVATED PICNIC DECK (LARGEST)**
- H. RECONFIGURED HALF BASKETBALL COURT**
- I. NEW BOCCE BALL LOCATION**

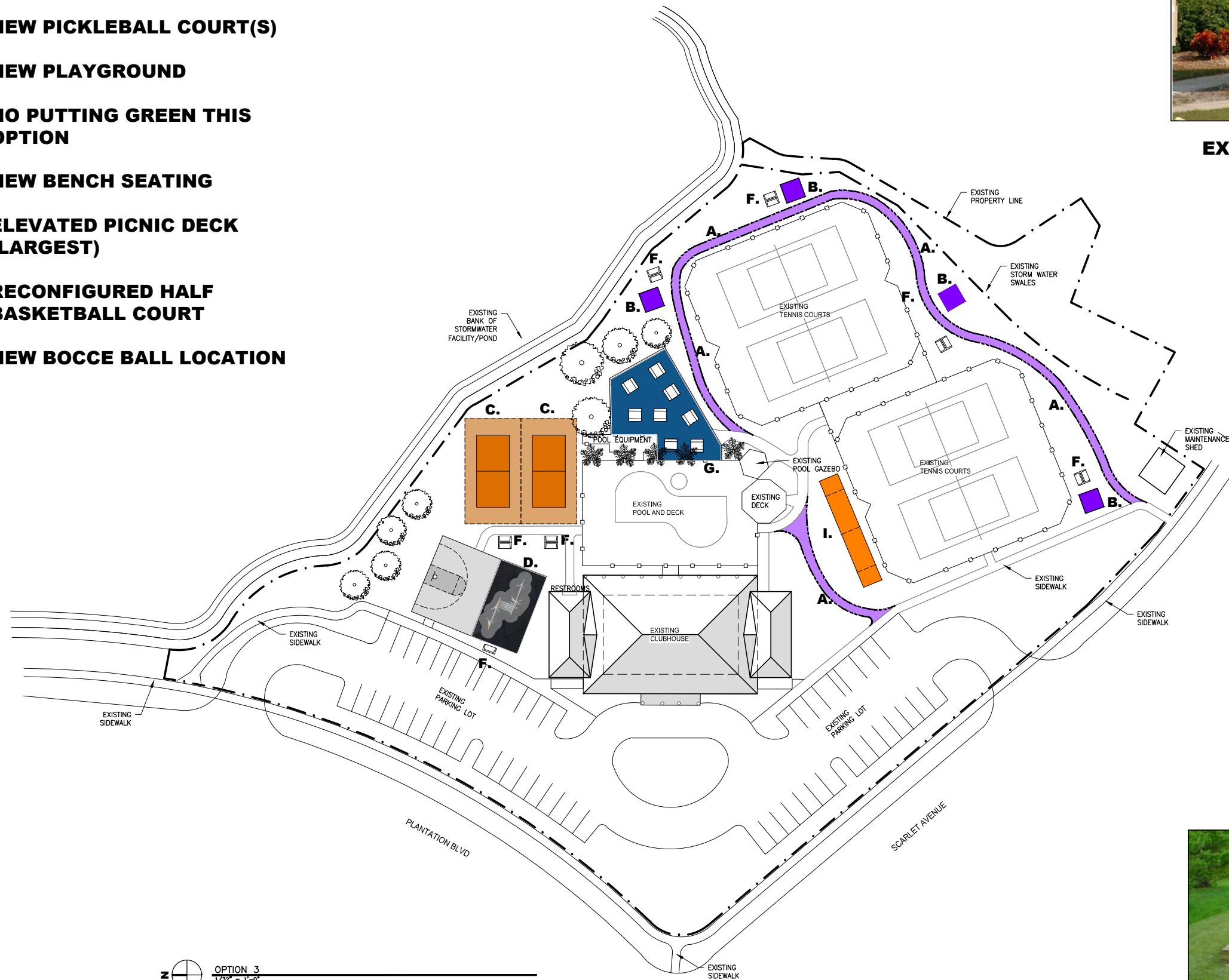

EXAMPLE COVERED BENCH (F.)
(UGARTE DESIGN MANATEE COUNTY PARKS AND ANNA MARIA ISLAND)



EXAMPLE BOCCE BALL (I.)
(CLUB SIZE)

OPTION 3
1/32" = 1'-0"

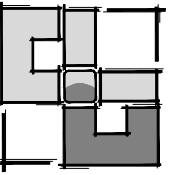

UGARTE & ASSOCIATES, INC.
ARCHITECTURE
PLANNING

434 9th AVENUE WEST
PALMETTO, FLORIDA 34221
PHONE (941) 729-5691
FAX (941) 729-5692
WWW.UGARTEARCHITECTURE.COM
— AA-C001654 —

SITE OPTION 3

LAKESIDE PLANTATION CDD

REVISIONS

PRELIMINARY
NOT FOR
CONSTRUCTION

PROJECT NO: 2016-01
DATE: -/-/-
DRAWN BY: -/-/-
CHKD BY: -/-/-

CARLOS D. UGARTE
LIC. NO. AR-0010725

SHEET
A300

4/16/2016 2:41 PM CAD_DWG_FILE:A300_SITE_OPTION_3.DWG COPYRIGHT: UGARTE & ASSOCIATES, INC. 2014